

## FLIGHT COMPARTMENT - MAINTENANCE PRACTICES

### 1. General

A. Flight compartment equipment and furnishings consist of the following items:

- (1) Pilot's Seat - Pilot's seat is standard equipment. It may be adjusted forward or aft, up or down and the seat angle changed.
- (2) Optional Copilot's (right) Seat - Optional copilot's (right) seat contains the same operating features as the pilot's seat.
- (3) Seat Belts and Shoulder Harness - On the 208 and 208B Passenger, the pilot and optional copilot (right) crew seats are equipped with a dual strap shoulder harness, lap belt and inertia reel which is fabricated as one assembly. Shoulder harness and lap belts are bolted to the lower seat frame, and the inertia reel is mounted at the bottom of the seat back frame. On the 208B, the pilot and optional copilot (right) crew seats are equipped with a five-point restraint system. This system consists of seat belts, a crotch strap and an inertia reel with double strap shoulder harness.
- (4) Removable Right Side Controls - Optional copilot (right) controls consist of the right side control wheel and right side rudder pedals. These controls are easily removed to allow for greater storage capacity. Refer to Chapter 27, Flight Controls - General, for topics related to control removal and installation.
- (5) Sunvisor - Sunvisors are provided as standard equipment for the pilot and optional copilot (right) crew seat positions. The sunvisors are fully adjustable and can be positioned as desired for maximum utilization. Removal and installation of the sunvisors is covered in Sunvisors - Maintenance Practices.
- (6) Beverage Cup Holder - Two beverage cup holders are mounted underneath the forward edge of the instrument panel. Removal and installation of the cup holders is covered in Beverage Cup Holder - Maintenance Practices.

### 2. Pilot and Optional Copilot (Right) Crew Seat Removal/Installation

A. Remove Seats (Refer to Figure 201).

- (1) Remove forward and aft seat rail stop bolts by removing nuts and two spacers from each position.
- (2) Pull seat release assembly handle forward to disengage seat locking pin.
- (3) Exert upward pressure on the seat and slide seat fore and aft until rollers and roller housings are clear of seat rail.
- (4) Lift seat up and away from seat rail.
- (5) Remove seat from airplane.

B. Install Seats (Refer to Figure 201).

- (1) Position seat on seat rail and slide fore and aft until rollers and roller housings engage seat rails.

**WARNING: It is extremely important that seat stop bolts are securely installed and seat locking pins are securely engaged. Acceleration and deceleration could permit seat to become disengaged from rails, creating a hazardous situation, especially during takeoff and landing.**

- (2) Install seat stop bolt, two spacers and nut in forward and aft holes of each seat rail.
- (3) Ensure locking pin mechanism functions correctly and that seat locking pin engages in seat rail.

**NOTE: Airplanes 20800021 and On and 20800001 thru 20800021 incorporating SK208-2 have an adjustable link installed on one side to enable full engagement of both locking pins.**

### 3. Seat Belt and Shoulder Harness Removal/Installation

A. Remove Lap-Belt Style Restraint System (Refer to Figure 201).

**NOTE: Shoulder harness, lap belt and inertia reel are one assembly and must be removed as a unit.**

- (1) Separate the upper section of seat back assembly from Velcro fasteners sufficiently to remove two screws attaching headrest to seat frame.
- (2) Remove headrest from seat frame.
- (3) Bend bottom flanges of seat back panel down and aft sufficiently to clear seat frame.
- (4) Pull seat back panel up sufficiently to gain access to inertia reel.
- (5) Remove bolts and nuts attaching inertia reel to seat back frame.
- (6) Remove nuts, washers, spacers and bolts attaching stirrups to seat frame.
- (7) Remove belts, stirrups and inertia reel from seat.

- B. Install Lap-Belt Style Restraint System (Refer to Figure 201).
  - (1) Install belts, stirrups and inertia reel on seats.
  - (2) Attach stirrups to seat frame using spacers, bolts, washers and nuts.
  - (3) Attach inertia reel to seat frame using bolts and nuts.
  - (4) Push seat back panel down until bottom flanges can be located below seat frame.
  - (5) Attach headrest to seat frame and install screws.
  - (6) Locate and attach upper section of seat back to Velcro fasteners on seat frame.
- C. Remove Five-Point Restraint System (Refer to Figure 201).
  - (1) Separate seat back cushion from Velcro fasteners and remove.
  - (2) Carefully bend inboard flanges of seat back panel out and around seat back frame so panel may be pulled back to gain access to inertia reel.
  - (3) Remove nuts, washers and bolts securing inertia reel to seat frame.
  - (4) Pull inertia reel out while feeding shoulder harness through slot beneath headrest.
  - (5) Remove nuts, washers, spacers and bolts securing stirrups to seat frame.
  - (6) Remove, nut, washer and bolt securing crotch strap to seat frame, and remove crotch strap.
- D. Install Five-Point Restraint System (Refer to Figure 201).
  - (1) With seat back panel pulled out away from seat, feed shoulder harness up and through slot beneath headrest.
  - (2) Position inertia reel to seat and secure using bolts, washers and nuts.
  - (3) Slide seat belt stirrups between seat back and seat cushion. Attach to seat frame using bolts, spacers, washers and nuts. Ensure buckle side of seat belt is installed on right side of seat.
  - (4) Slide stirrup end of crotch strap down through slot at forward end of seat cushion and attach to seat frame using bolt, washer and nut.
  - (5) Carefully bend inboard flanges of seat back panel out and around seat back frame to install panel.
  - (6) Install seat back cushion on Velcro fasteners.

#### 4. Armrest Removal/Installation

**NOTE:** Left and right armrest removal/installation procedures are typical.

- A. Remove Armrest (Refer to Figure 201).
  - (1) Remove bolt, washers and armrest from crew seat.
- B. Install Armrest (Refer to Figure 201).
  - (1) Position washers and armrest to crew seat and secure using bolt.

Figure 201 : Sheet 1 : Crew Seat Installation

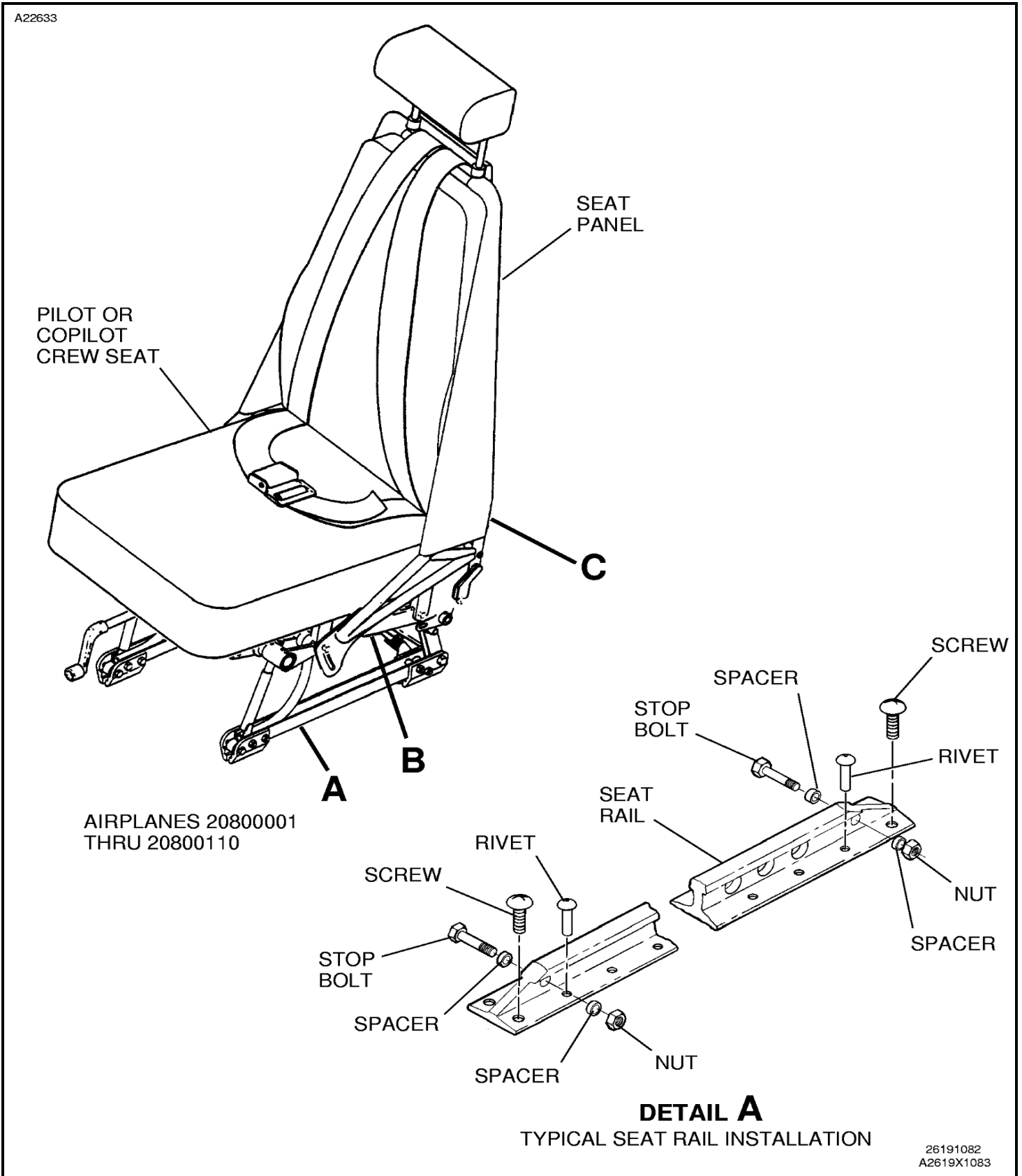
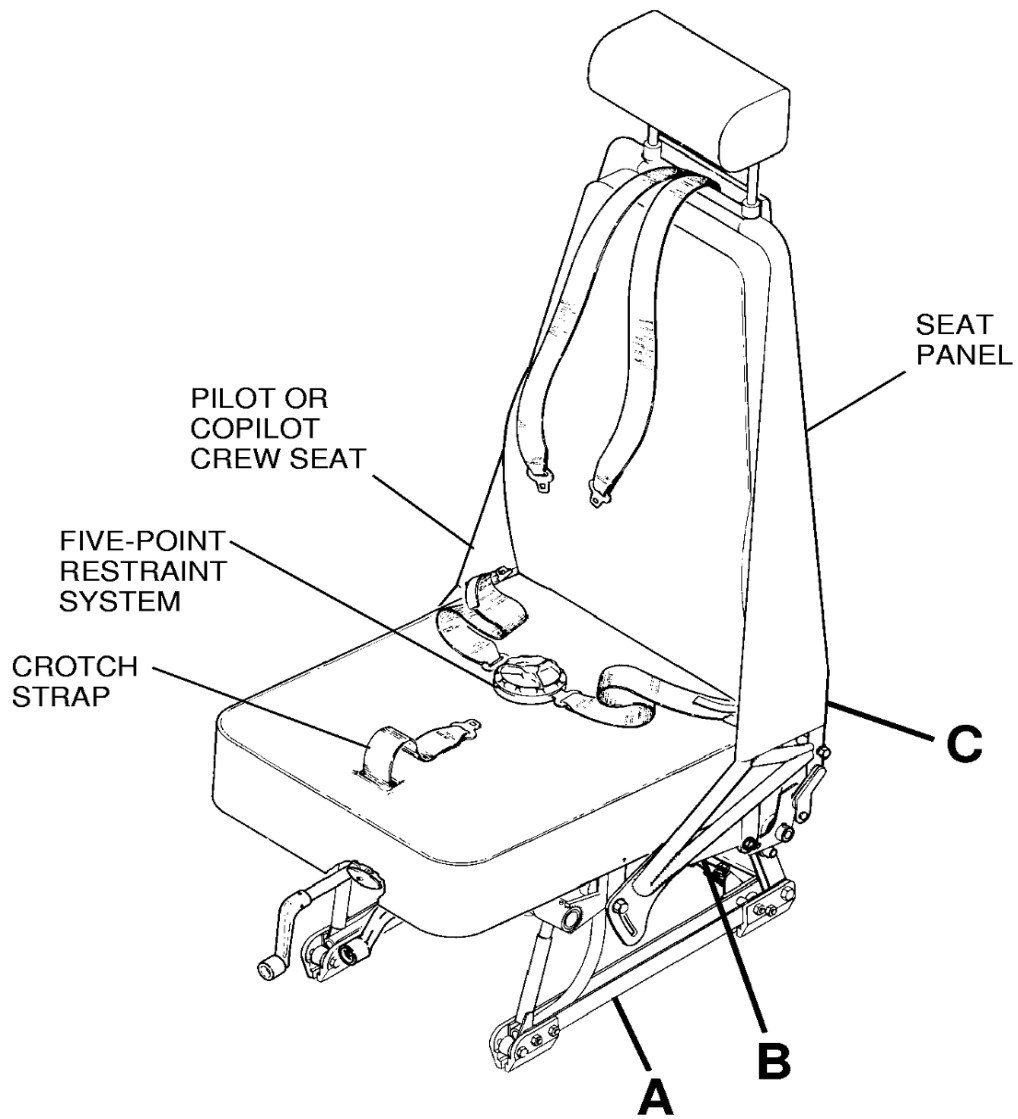

Figure 201 : Sheet 2 : Crew Seat Installation

A22634



AIRPLANES 20800111 THRU 20800237  
AND AIRPLANES 208B0001 THRU 208B0381

26192017

Figure 201 : Sheet 3 : Crew Seat Installation

A22635

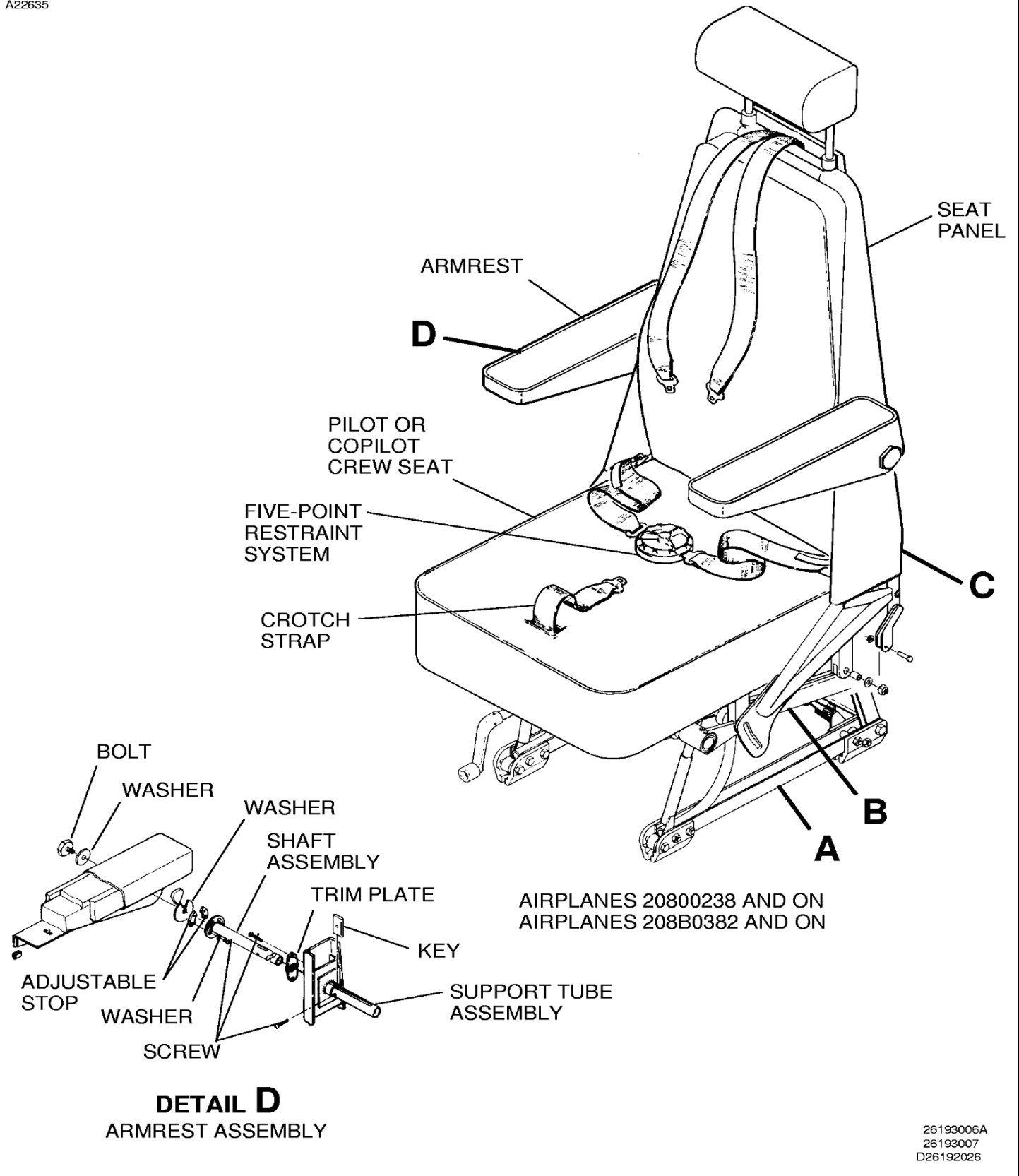
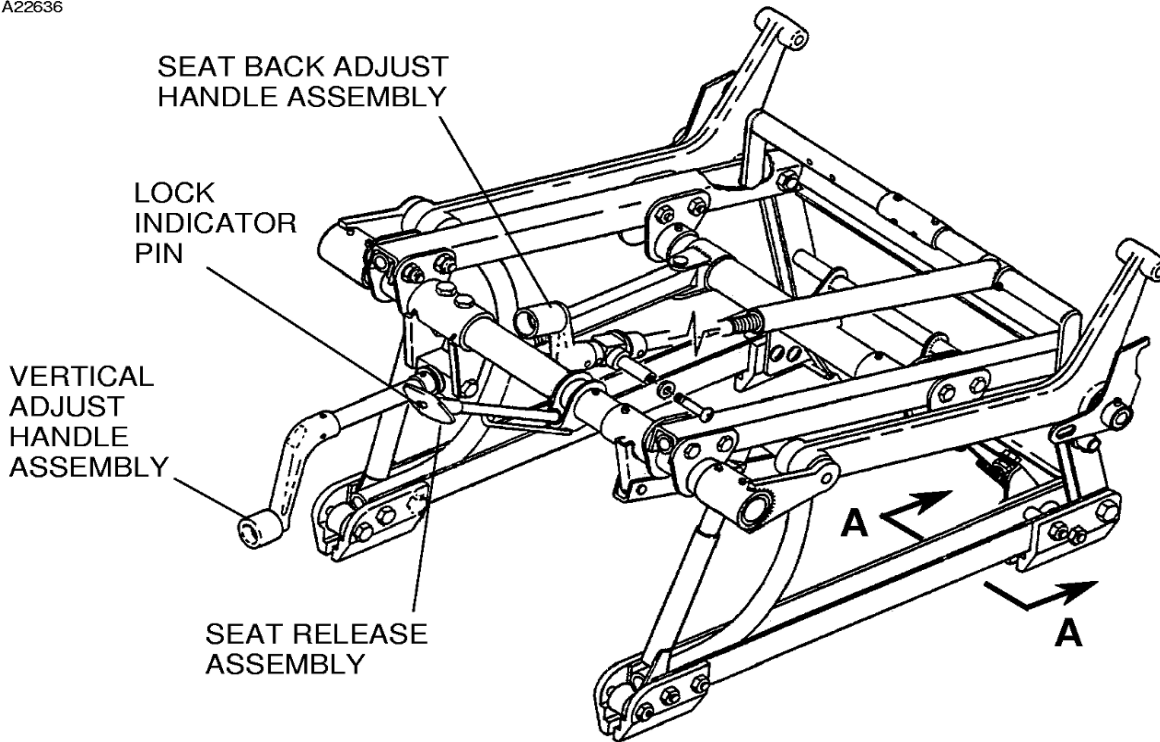

Figure 201 : Sheet 4 : Crew Seat Installation

A22636



**DETAIL B**

**NOTE 2:** AIRPLANES 20800021 AND ON AND 208B00001 AND ON AND AIRPLANES 20800001 THRU 20800020 INCORPORATING SK208-2

**NOTE 1:** SEAT LOCKING PIN MUST INSTALL THROUGH ROLLER HOUSING AND EXTEND SLIGHTLY BEYOND

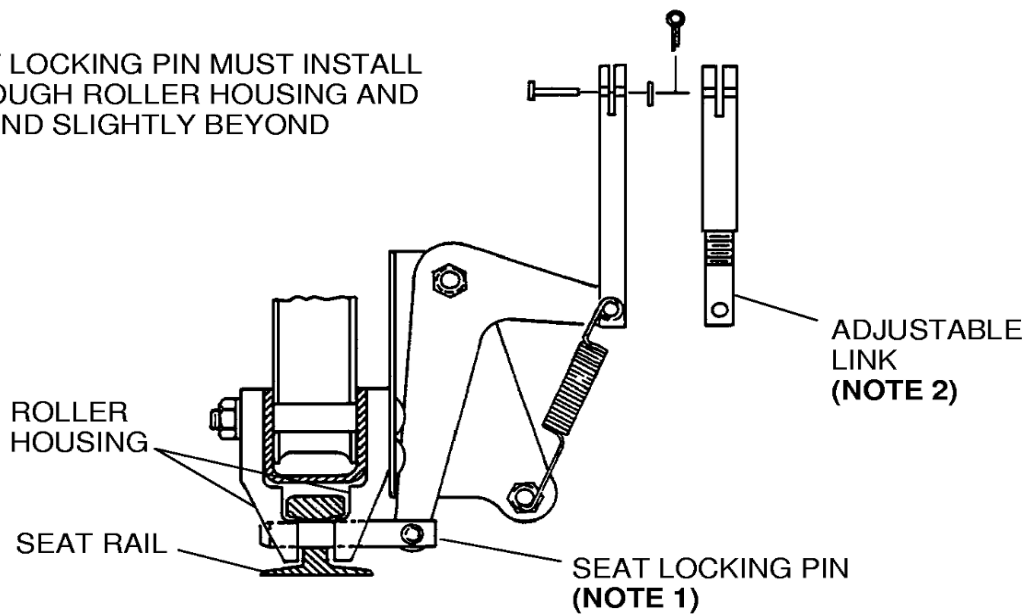

**VIEW A-A**

B2619X1084  
AA2619X1085

Figure 201 : Sheet 5 : Crew Seat Installation

A22637

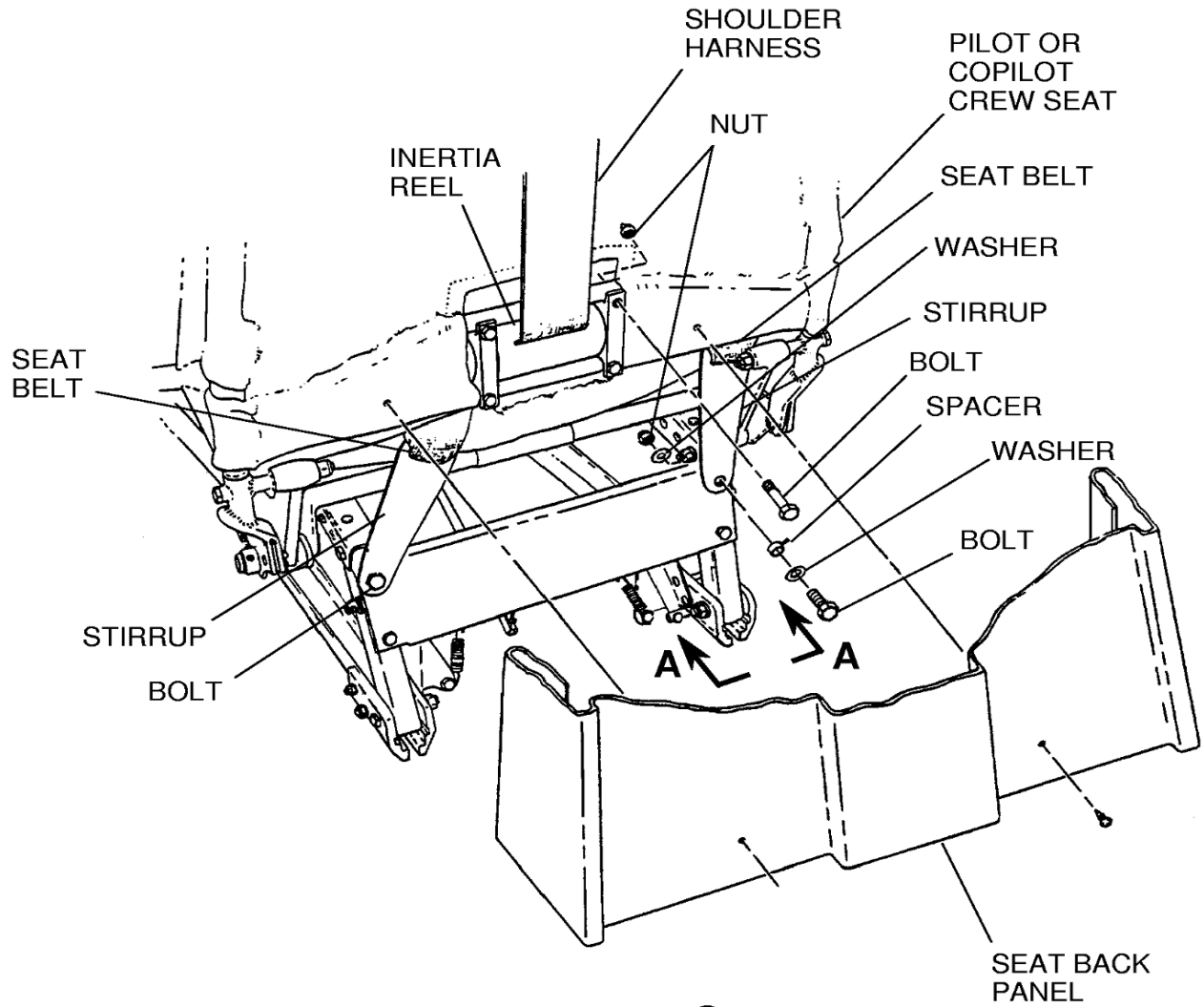

**DETAIL C**

AIRPLANES 20800001 THRU 20800110

C2619X1086

Figure 201 : Sheet 6 : Crew Seat Installation

A22638

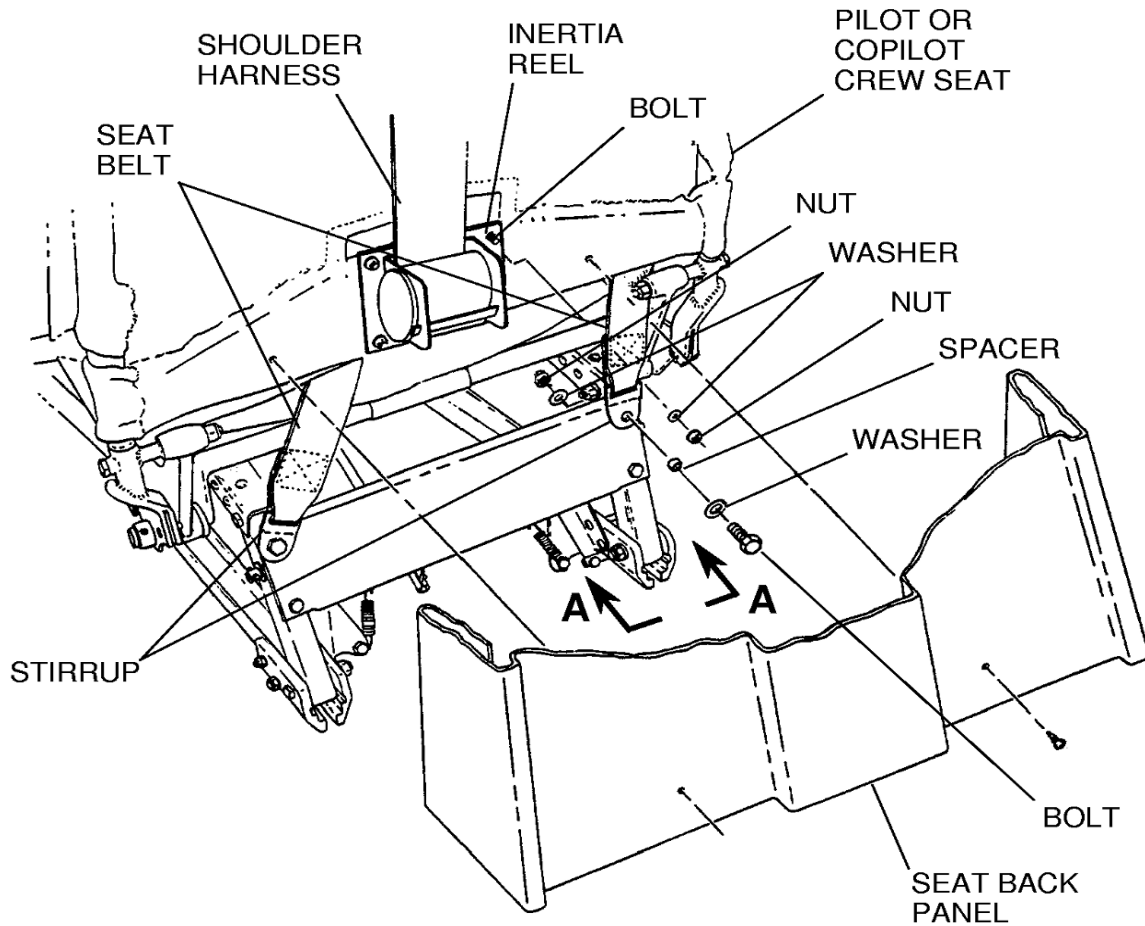

**DETAIL C**

AIRPLANES 20800111 AND ON  
AND AIRPLANES 208B00001 AND ON

C2619X1087